

# Technical data sheet



## BTALU Concealed Beam Hanger

The BTALU concealed hanger is one solution to connecting timber members together without seeing the connector. It is designed to be fixed to the header timber and then fully inserted into a slot in the in-coming beam, and held in place with dowels. Holes are drilled through the timber and fin of the BTALU, allowing accurate alignment. This method provides an aesthetically pleasing connection for feature beams.

Note: Fasteners & dowels supplied; dowel length must be specified upon ordering  
Holes for the joist have to be site drilled in accordance to positions shown in diagram below.



### Features

#### Material

**Aluminium**

#### Benefits

- Accurate alignment of dowels
- Aesthetically pleasing

### Applications

#### For Connecting

**Glulam timbers**

#### For Use With

**Carried and carrying Glulam member**

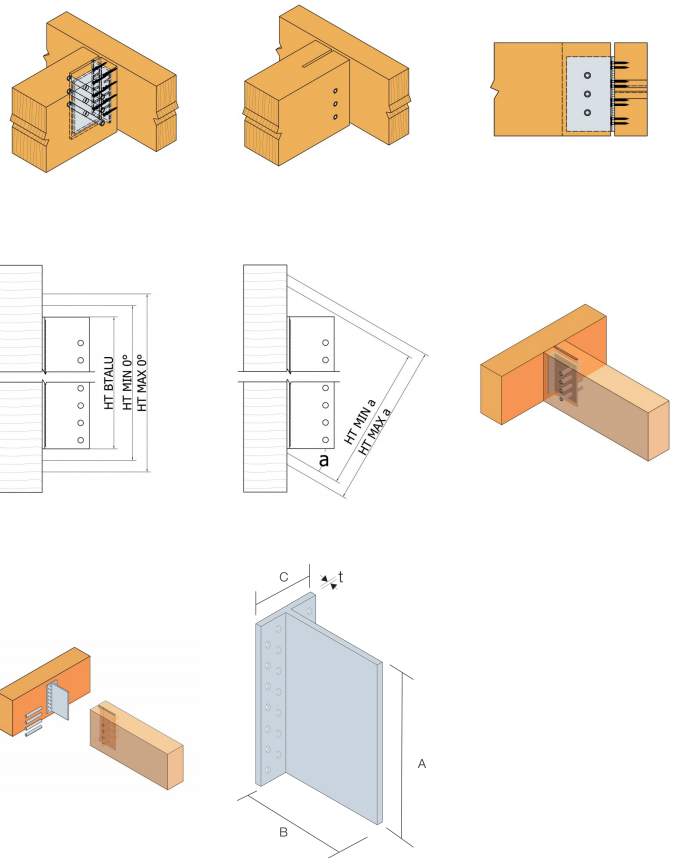

## BTALU Concealed Beam Hanger

### Technical Data

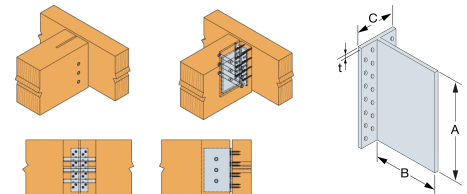

#### Product Dimensions

References	Tun / DB nr.	Product Dimensions [mm]				Header holes	Box Quantity
		A	B	C	t	Ø5	
BTALU90	1862485	86	109	62	6	16	25
BTALU120	1821910	116	109	62	6	20	25
BTALU160	1821917	156	109	62	6	28	25
BTALU200	1862489	196	109	62	6	36	15
BTALU240	1821920	236	109	62	6	44	15

The holes for the joist has to be drill acc. to the hole pattern of the ETA.  
The size A can be up to 4mm less for cutting from the raw length, the cut shall be between the nail holes.

#### Performance Values

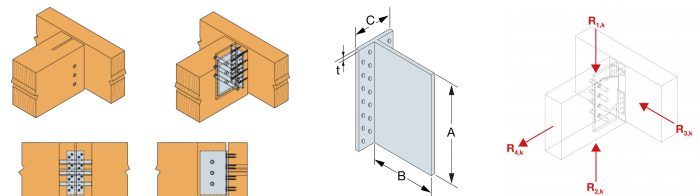

References	Product Capacities [kN]									
	Number of Fasteners				$R_{1,k} = R_{2,k}$					
	Header		Joist		Dowels length [mm]					
	Qty	Type	Qty	Type	60	80	100	120	140	160
BTALU90	16	CNA4.0x50	4	STD8	10.8	11.8	12.9	13.7	13.7	13.7
BTALU120	20	CNA4.0x50	3	STD12	17.3	18.2	19.4	20.7	22.3	23.9
BTALU160	28	CNA4.0x50	4	STD12	28	29.5	31.2	33.3	35.7	38.2
BTALU200	36	CNA4.0x50	5	STD12	39.8	41.9	44.3	47.2	50.4	53.9
BTALU240	44	CNA4.0x50	6	STD12	52.2	54.9	57.9	61.7	65.9	70.3

The joist shall have as minimum a width = length of steel dowel.  
For beams with a slope  $\beta$  the capacities shall be multiply with the factor.

$\beta$	0°	15°	30°	45°
factor	1.0	0.95	0.90	0.85

It's only necessary for connection with less than 7 steel dowel in the joist.

## BTALU Concealed Beam Hanger

### Installation

#### Fixing

CNA4,0xL

